



PT1200

Ceramic Pressure Transmitter

Feature

- ☆ $\pm 0.5, \pm 1\%$ F.S Accuracy
- ☆ High stability, High reliability
- ☆ Ceramic sensor from Germany
- ☆ Digital Calibration
- ☆ Multiple connectors and ports
- ☆ Zero point can be shifted freely
- ☆ Measurement range shifted 50~100%
- ☆ CE, RoHS approved

Application

- ☆ Compressor
- ☆ Building water supply
- ☆ Hydraulic control
- ☆ Air conditioner
- ☆ Auto Engine
- ☆ Automatic detecting system
- ☆ Hydraulic pressure station
- ☆ Refrigerator



Description

CS-PT1200 series of pressure transmitters feature high quality, high stability, small size, low weight, compact structure, low cost and mass production. The products are widely used to measure pressure of air compressors, auto engines, air conditioning equipment, etc.

Stainless steel housings are ideal for industrial environment. Pressure sensing elements are selected from well known international brands. Special circuits are adopted to adjust zero and full range conveniently. The products have been approved with CE, intrinsically safe, and explosion-proof certificates.

Non-polar two-wire current and three-wire voltage output are provided.

Products are produced according to military standards of advanced design, perfect technology, scientific management, strict production and quality control and have been sold to over 50 countries.

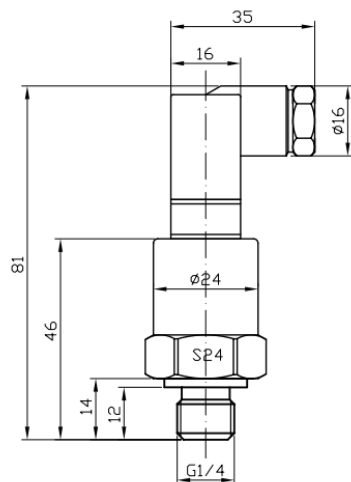



Technical parameters

Parameter	Value		Note
Measurement range	0~2bar.....600bar		1bar=100kpa
Overload pressure	1.5 * pressure range		
Broken pressure	3 * pressure range		
Accuracy	±0.5%F.S ±1%F.S		
Stability	Typical 0.5% F.S, Maximum: 1 %F.S		
Operating temperature	-40°C~100°C		
Compensation temperature	-10°C~80°C		
Medium compatibility	Corrosive medium compatible with 1Cr18Ni9Ti,Ceramic		
Wires	Two-wire	Three-wire	
Output signal	4~20mA	0.5-4.5V	
Supply voltage	10~30Vdc	5Vdc 10-30Vdc	
Load resistance	(U-10)/0.02(Ω)	>100KΩ	
Insulation	>100M Ω@50V		
Electrical connection	DIN43650, Packard,M12 Seial, Cable		
Shell/Wire protection	IP67		
Pressure form	Gauge G, Absolute A		
Pressure port	G1/2 G1/4 NPT1/4 M20×1.5 7/16-20UNF		
Response time	10ms		
Certification	CE,Intrinsic-safety explosion E, Isolated explosion-proof D		
EMC	EMI:EN50081-1/-2, EMS:EN50082-2		

Type Selection Guide

PT1200

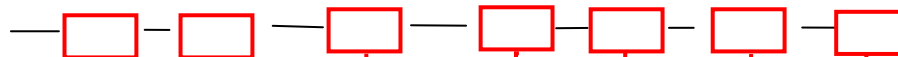

Range:

K=kPa, M=Mpa, P=PSI,B=bar

Output signal

A=4~20 mA,V=0.5-4.5V;

Accuracy Level

0.5=0.5%F.S. 1=1%F.S

Electrical Connection

P=Packard, D=DIN 43650c, C=directly leads, CW=cable glands leads;

Pressure Port

G1=G1/2, G=G1/4, N= NPT1/4, M=M20×1.5,U= 7/16-20UNF

PT1200A - Current

PT1200V- Voltage

Pressure Form:

G=gague;
A=absolute

Cable Length:

X m